

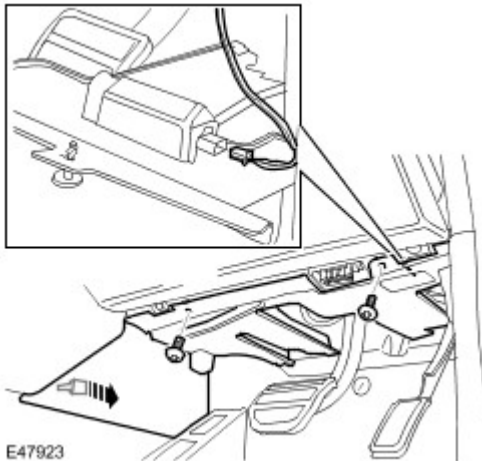

Accelerator Pedal (19.20.01)

Removal

1. Remove the driver side closing trim panel.
 - Release the clip.
 - Remove the 2 screws.
 - Disconnect the electrical connector.



2. Remove the accelerator pedal assembly.
 - Release the wiring harness.
 - Remove the 3 nuts.
 - Disconnect the electrical connector.

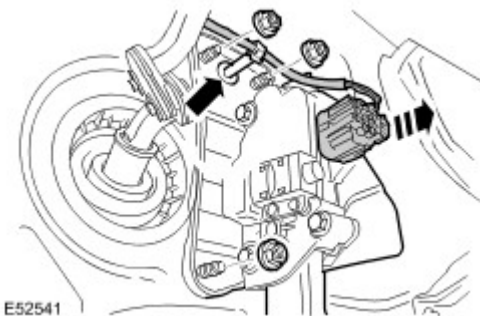

3. **NOTE :**
Do not disassemble further if the component is removed for access only.
Remove the accelerator pedal bracket.
 - Remove the 3 nuts and bolts.

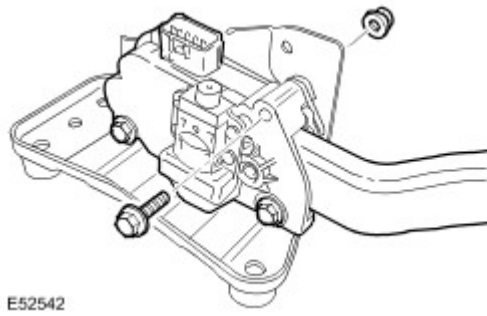

Installation

- 1 . Attach the accelerator pedal bracket.
 - Tighten the nuts and bolts to 10 Nm (7 lb.ft).
- 2 . **NOTE :**
Make sure the electrical connector is securely connected.
Install the accelerator pedal assembly.
 - Connect the electrical connector.
 - Tighten the nuts to 25 Nm (18 lb.ft).
 - Secure the wiring harness.
- 3 . Install the closing trim panel.
 - Connect the electrical connector.
 - Secure the clip.
 - Tighten the screws.
- 4 . Initiate a new accelerator pedal using T4.